

Diethard Thieme
Skripte zur Baumechanik

Übungen
mit
Lösungen
BM 44

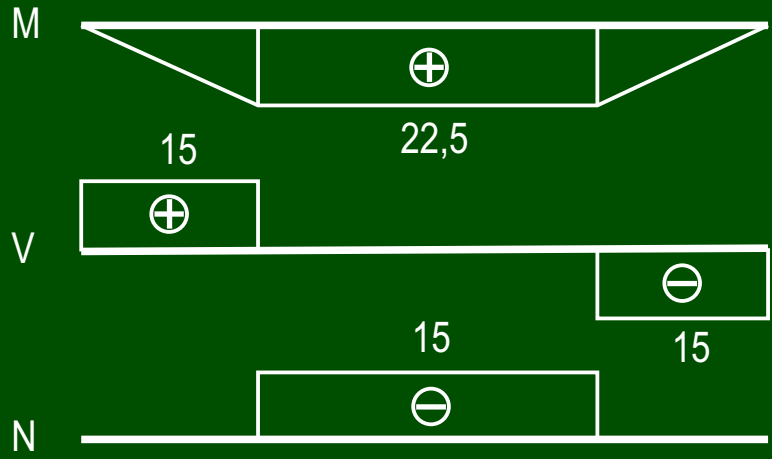

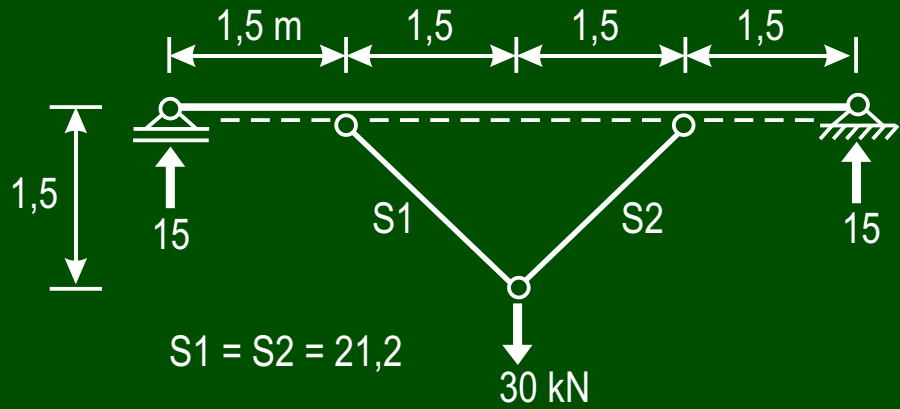

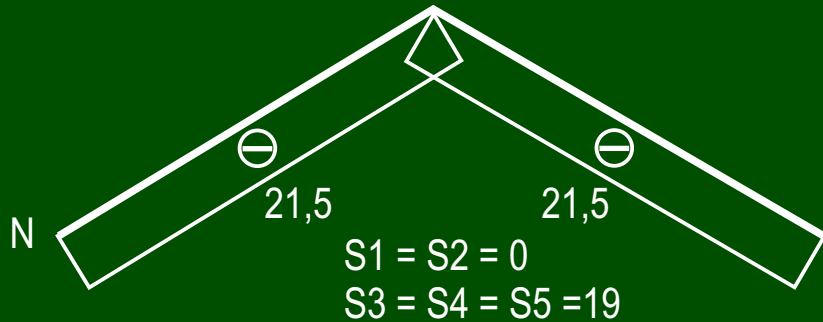
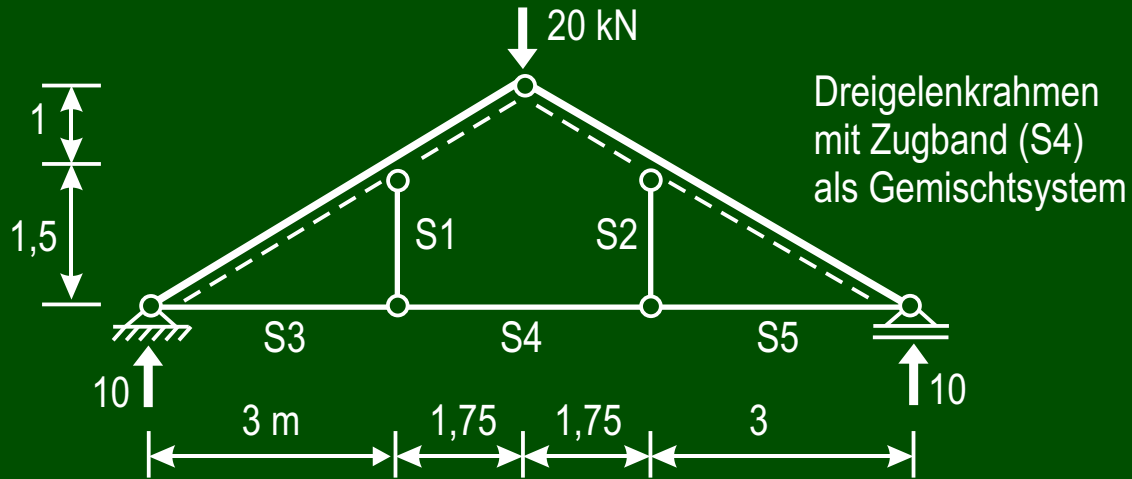
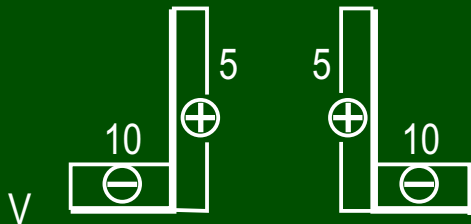
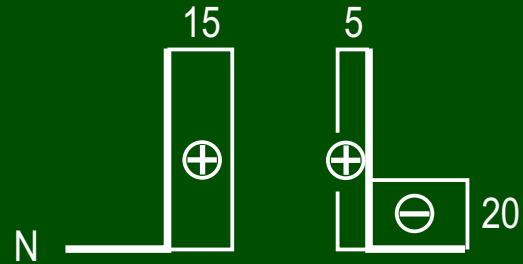
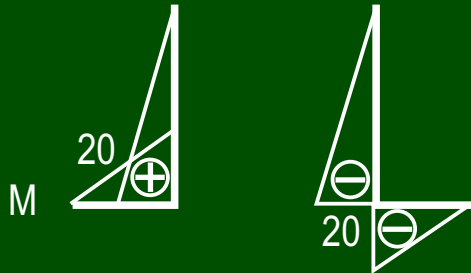
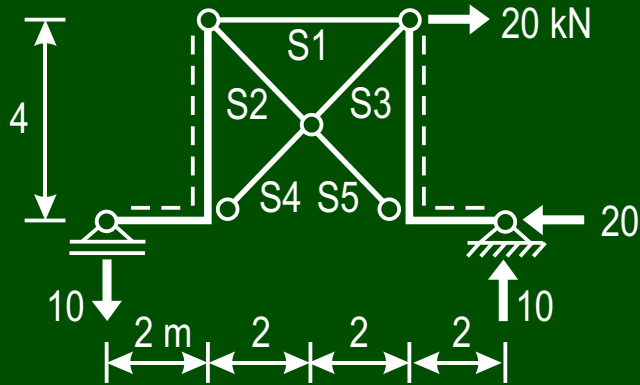

- S1 = 20
- S2 = - 21,2
- S3 = - 7,07
- S4 = - 7,07
- S5 = - 21,2

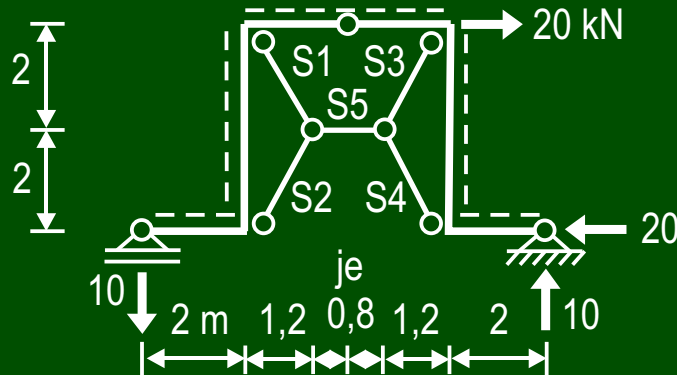

- S1 = - 19,4
- S2 = - 19,4
- S3 = -19,4
- S4 = -19,4
- S5 = 20

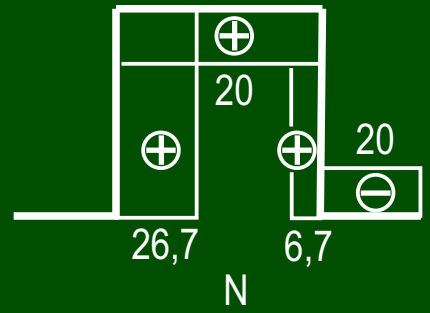
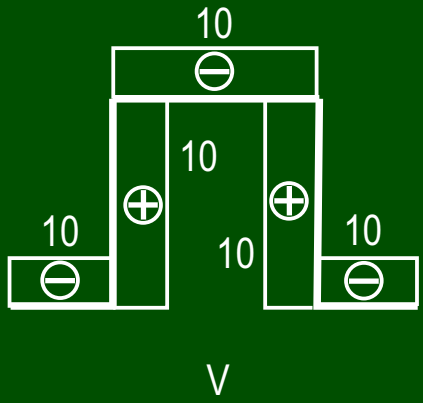
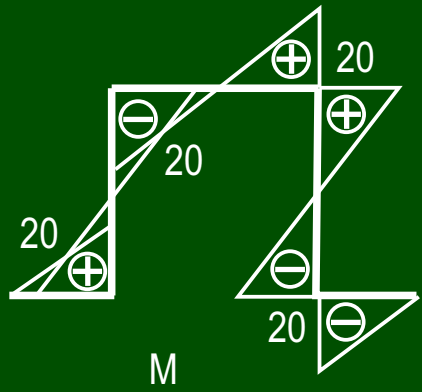

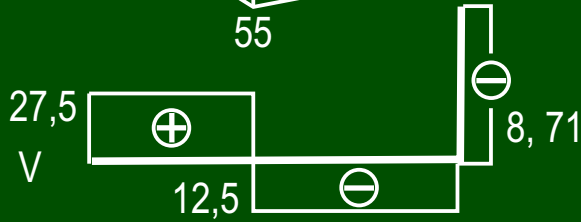
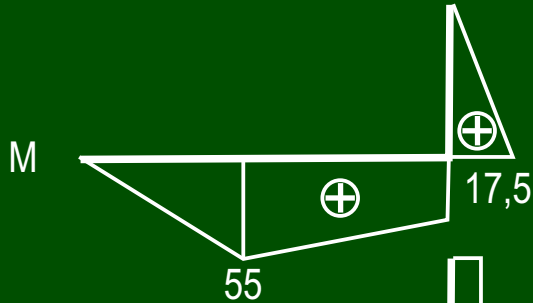
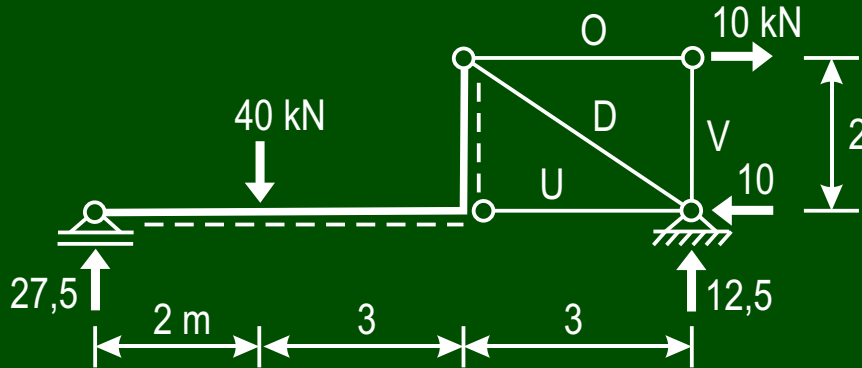

$$\begin{aligned}
 O &= 10 \\
 U &= 8,71 \\
 V &= 0 \\
 D &= -22,5
 \end{aligned}$$

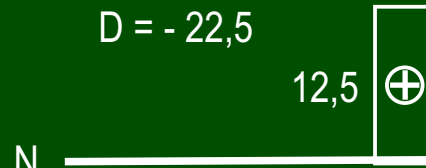

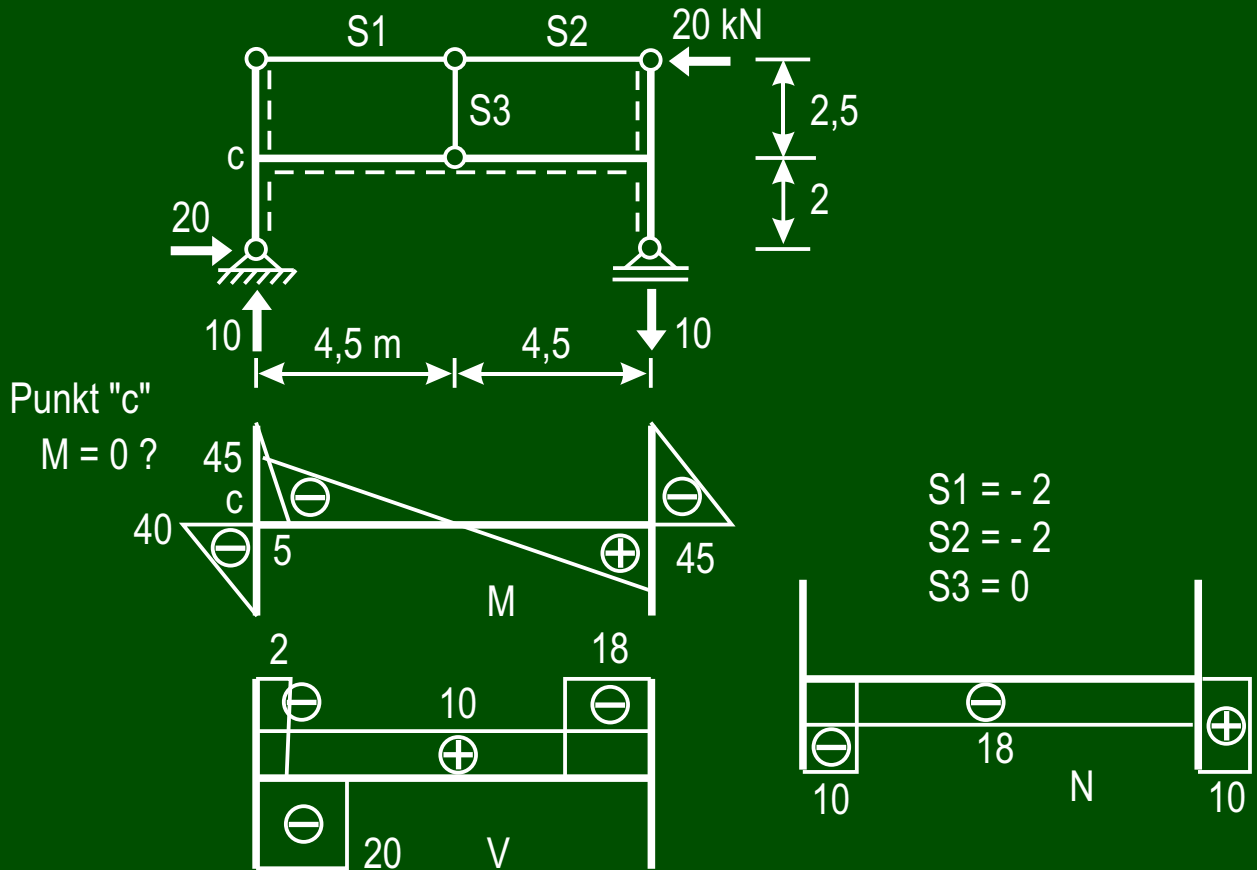

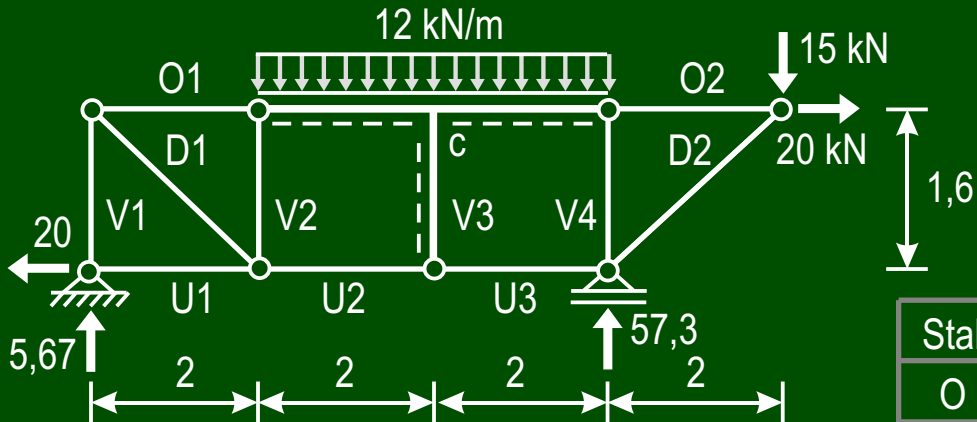

Stab	1	2	3
O	-7,08	38,75	
U	20	27,08	-18,75
V	-5,67	-5,67	-42,3
D	9,07	-24	

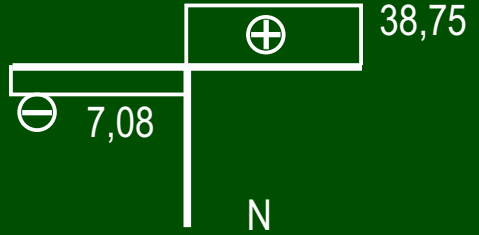
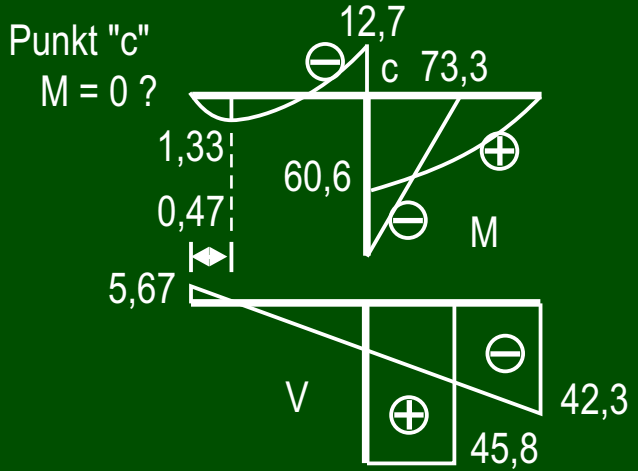

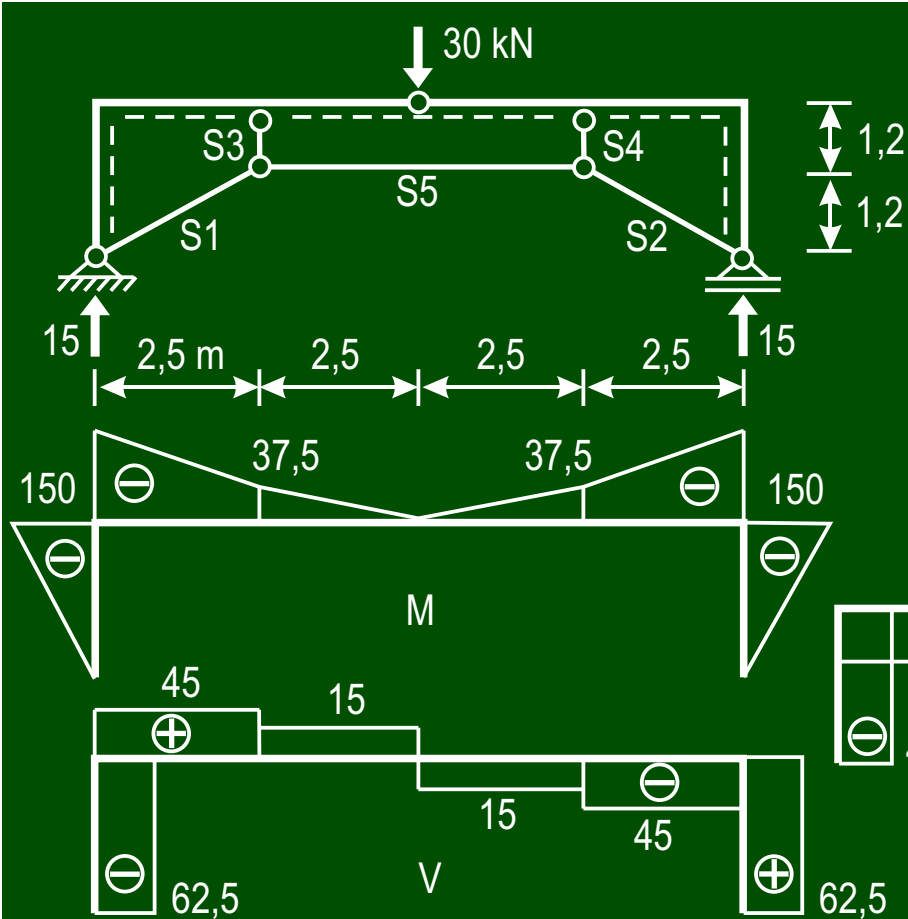

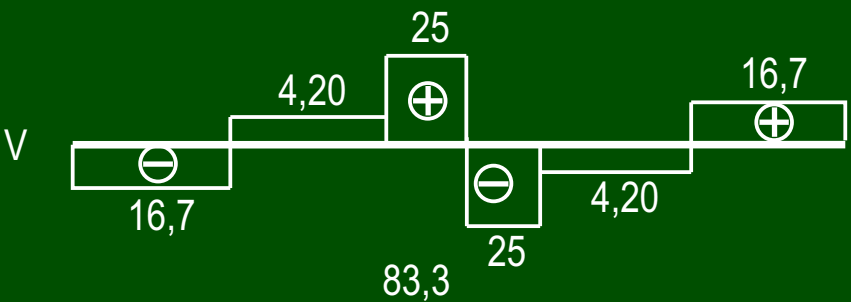
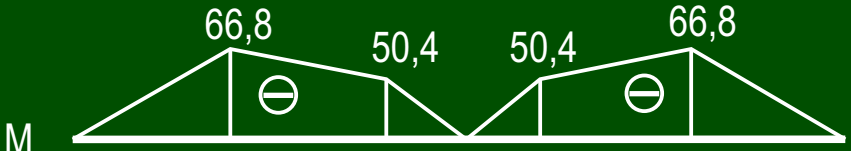
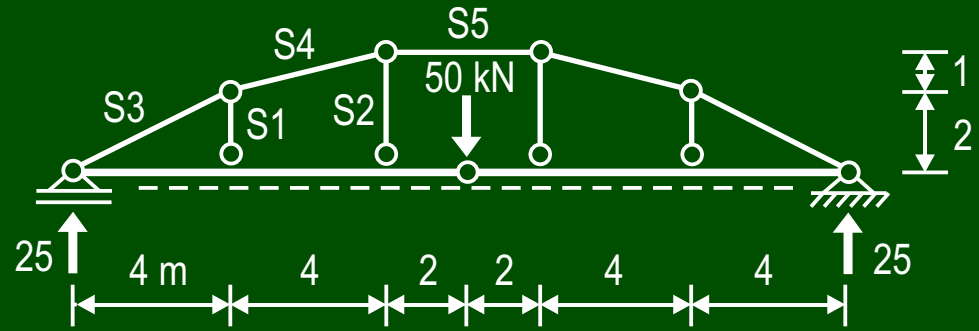

- S1 = S2 = 20,8
- S3 = - 93,2
- S4 = - 85,9
- S5 = - 83,3

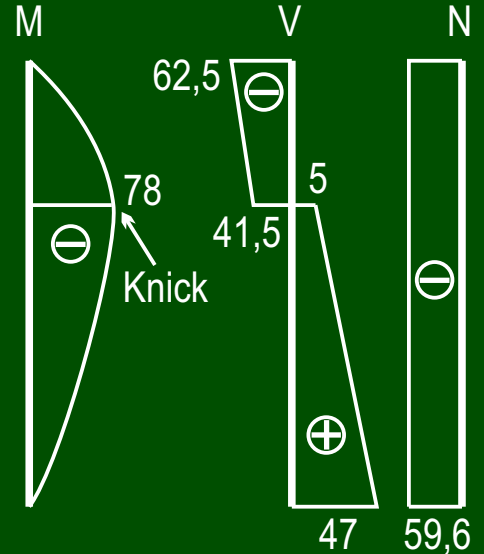
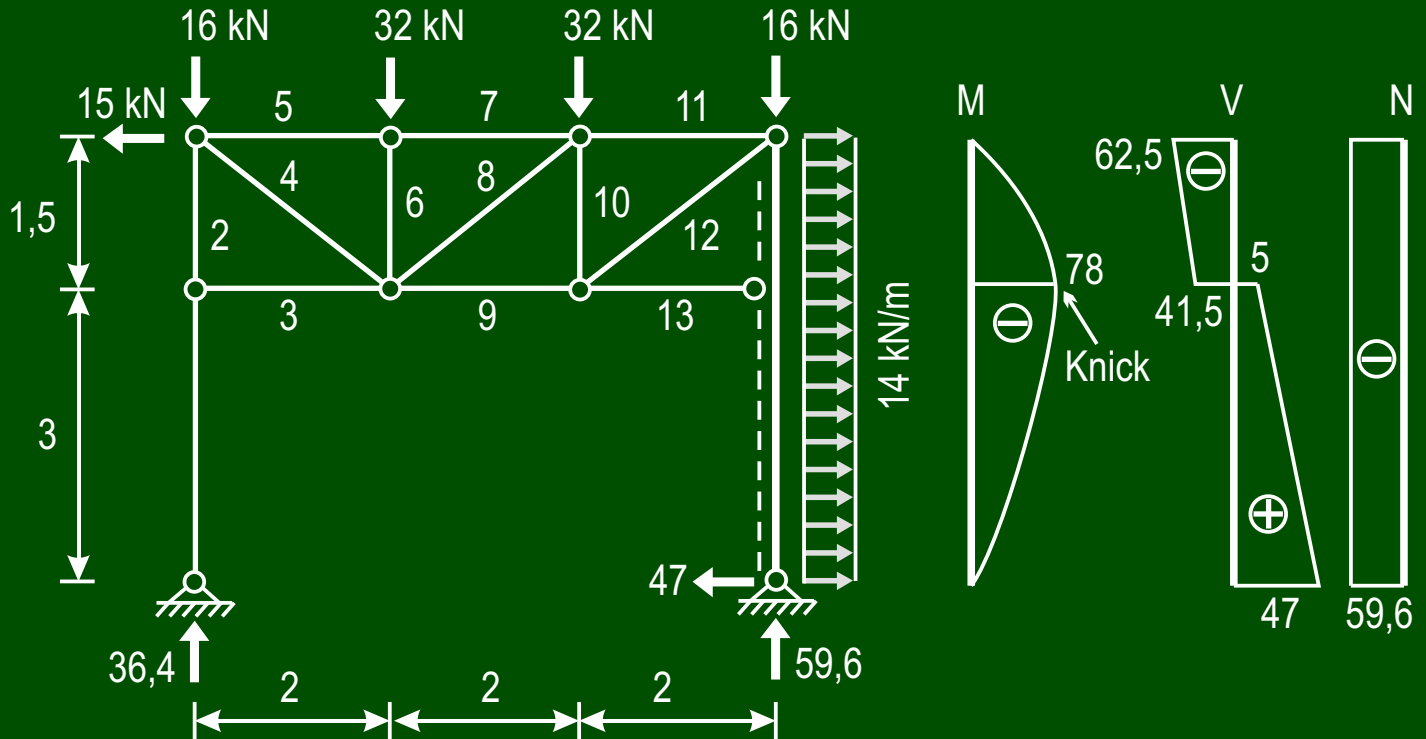

$S_1 = -36,4$	$S_4 = 33,9$	$S_7 = -11,2$	$S_{10} = -43,6$	$S_{13} = -46,5$
$S_2 = -36,4$	$S_5 = -11,2$	$S_8 = 19,4$	$S_{11} = 4,33$	
$S_3 = 0$	$S_6 = -32$	$S_9 = 11,7$	$S_{12} = 72,7$	

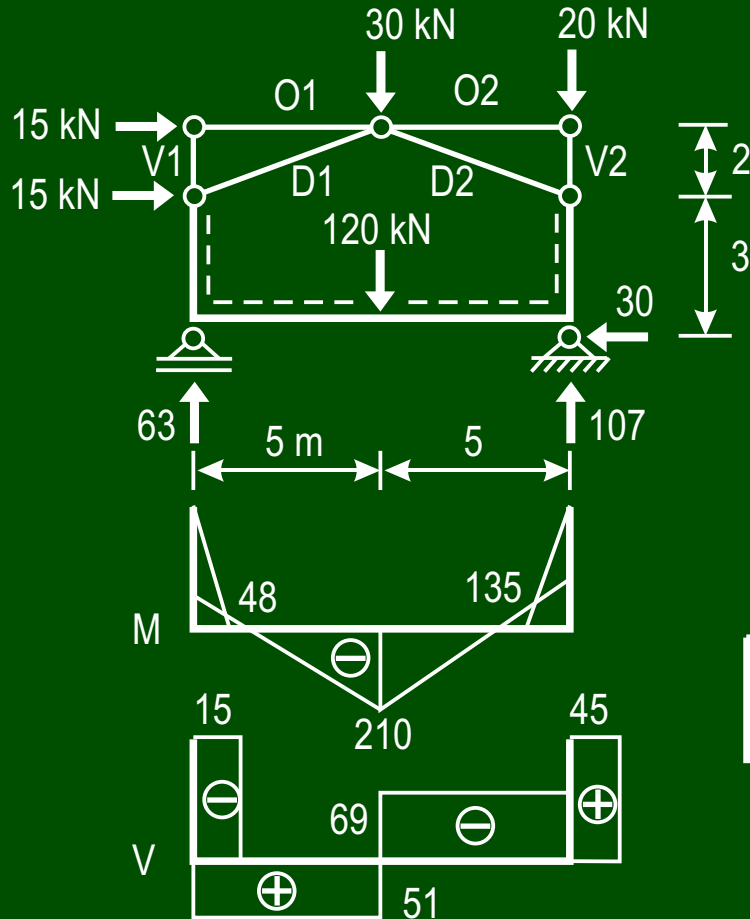

Auf dem geknickten
 Träger sitzt ein
 Dreigelenkrahmen aus
 zwei Fachwerkscheiben

$$\begin{aligned}
 O_1 &= -15 \\
 O_2 &= 0 \\
 V_1 &= 0 \\
 V_2 &= -20 \\
 D_1 &= -32,3 \\
 D_2 &= -48,5
 \end{aligned}$$

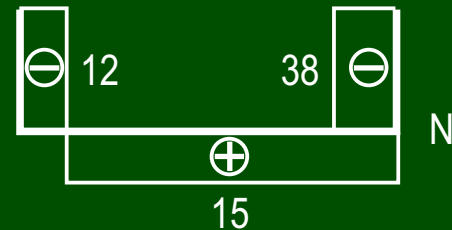

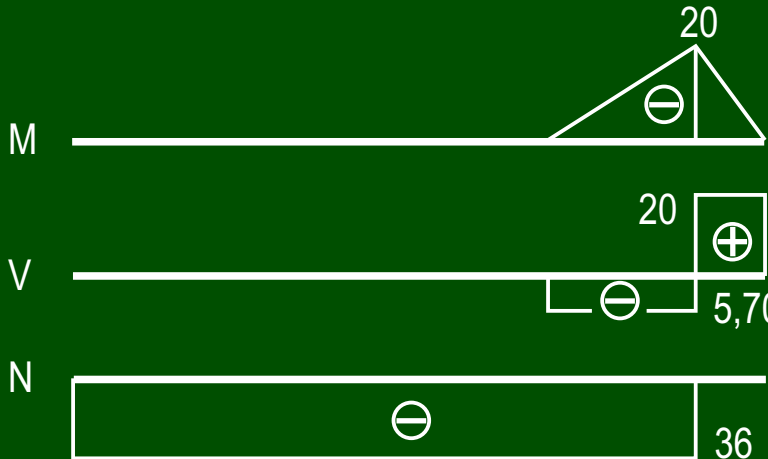
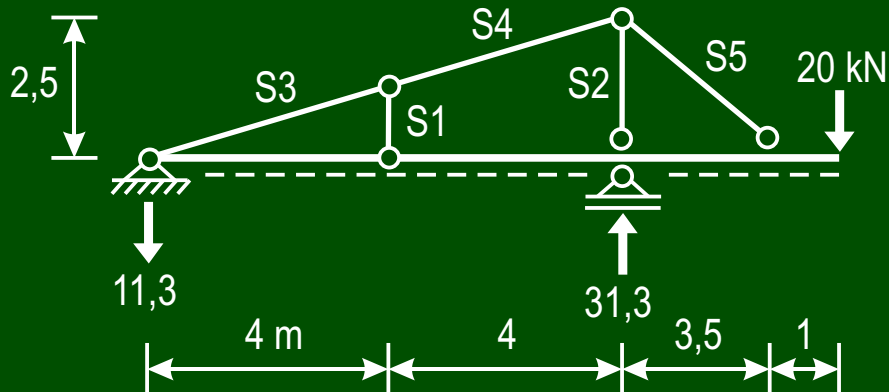

$$\begin{aligned}
 S1 &= 0 \\
 S2 &= -37 \\
 S3 &= S4 = 37,8 \\
 S5 &= 44,2
 \end{aligned}$$

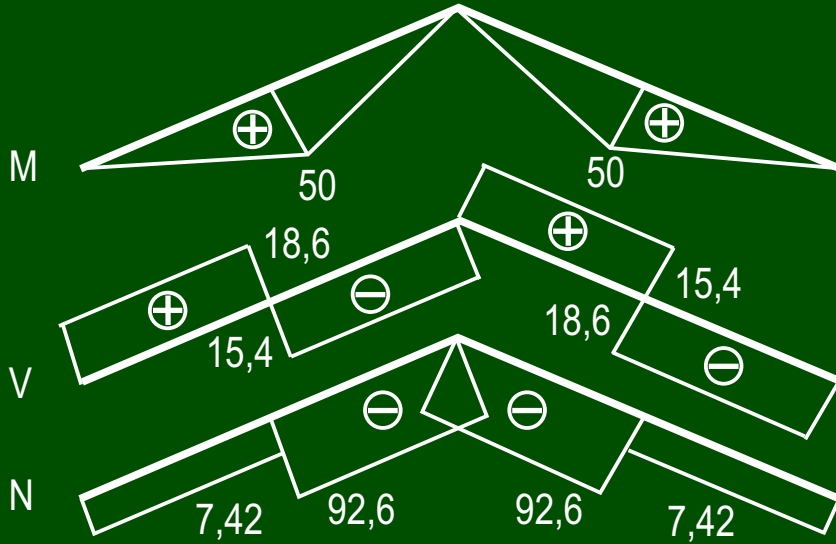
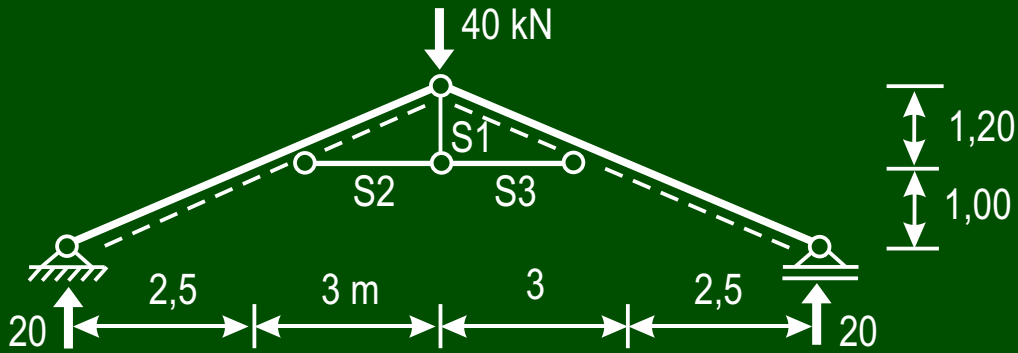

$$S1 = 0$$

$$S2 = S3 = 91,7$$

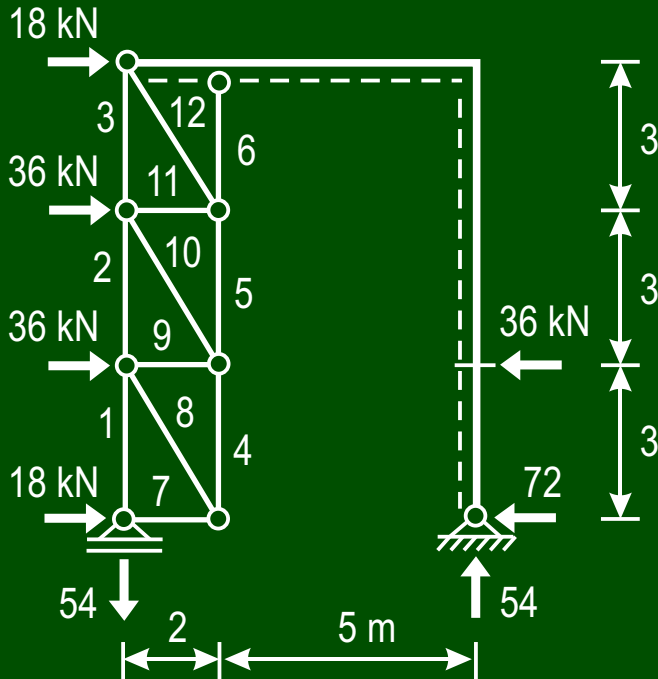

$S1 = 54$	$S5 = -108$	$S9 = -54$
$S2 = 81$	$S6 = -243$	$S10 = 97,4$
$S3 = 162$	$S7 = -18$	$S11 = -90$
$S4 = -27$	$S8 = 32,4$	$S12 = 162,2$

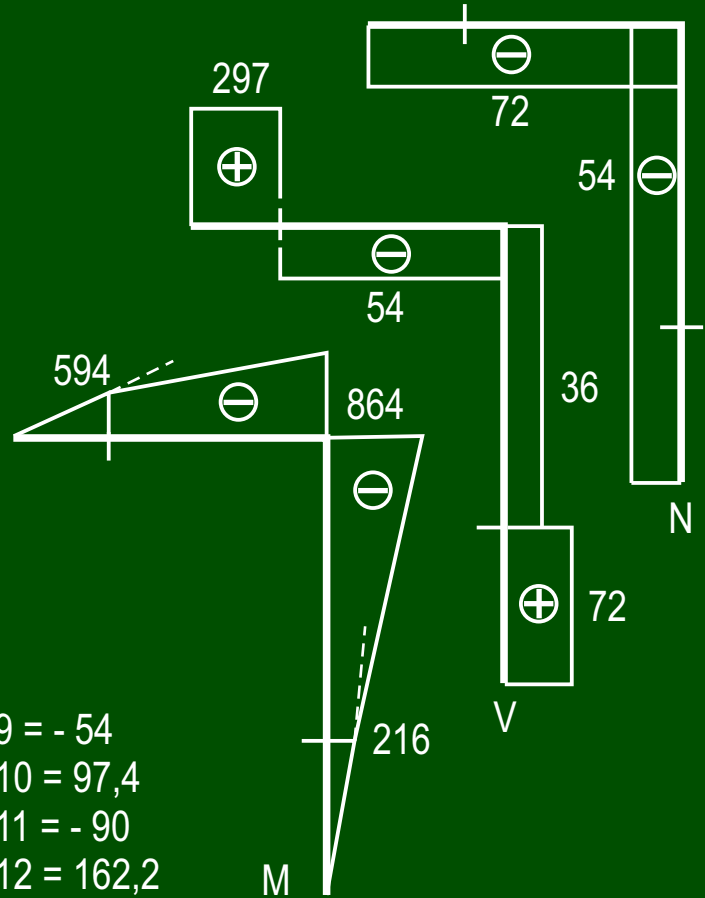

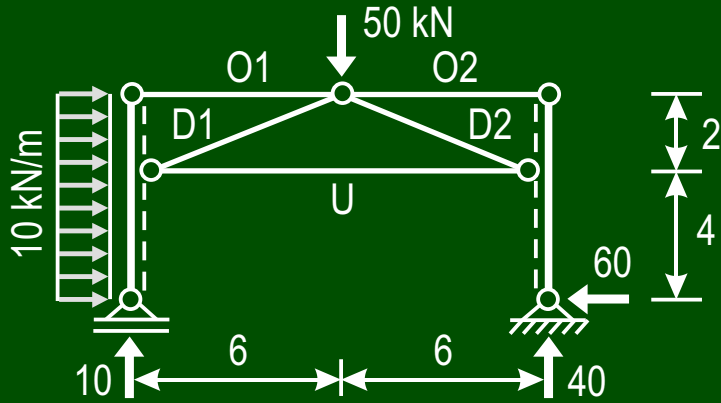

$O1 = 30$
 $O2 = 120$
 $D1 = -31,6$
 $D2 = -126,5$
 $U = -60$

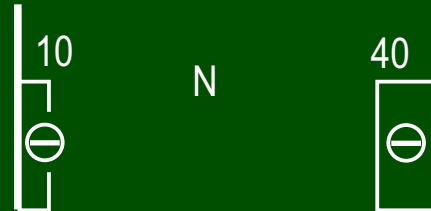
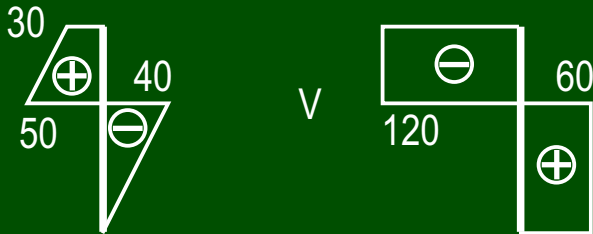

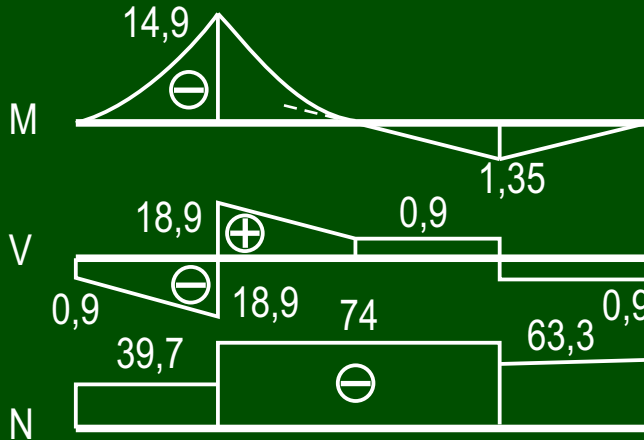
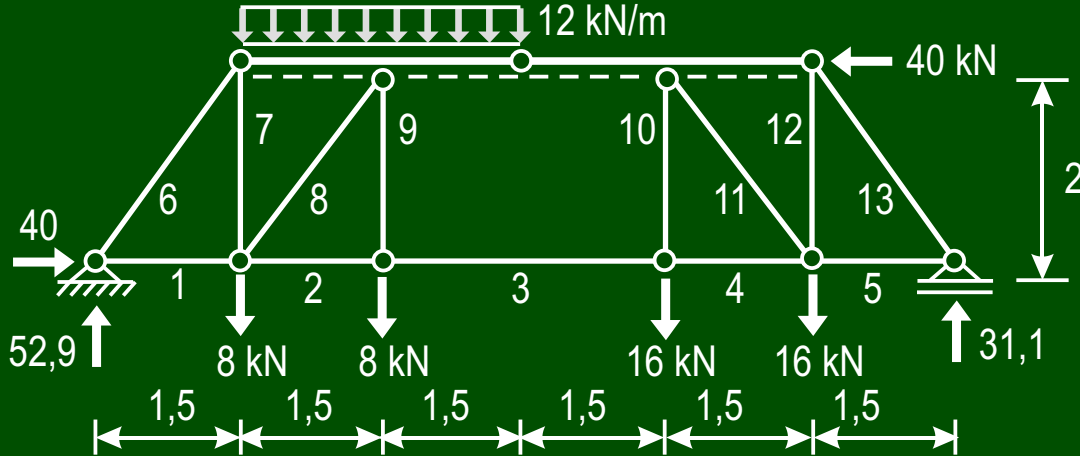

$S_1 = -0,33$	$S_8 = -57,2$
$S_2 = 34$	$S_9 = 8$
$S_3 = 34$	$S_{10} = 16$
$S_4 = 34$	$S_{11} = -17,8$
$S_5 = 23,3$	$S_{12} = 30,2$
$S_6 = -66,1$	$S_{13} = -38,9$
$S_7 = 53,8$	

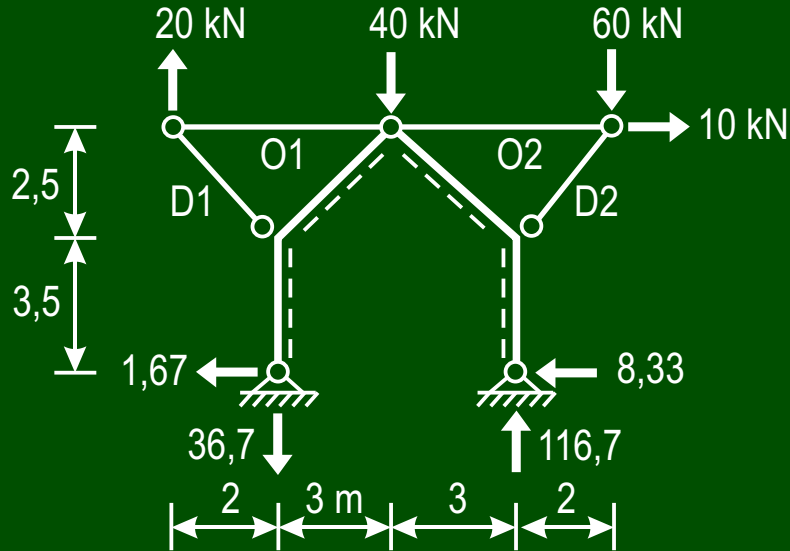

$O1 = -16$
 $O2 = 58$
 $O3 = 25,6$
 $D2 = -76,8$

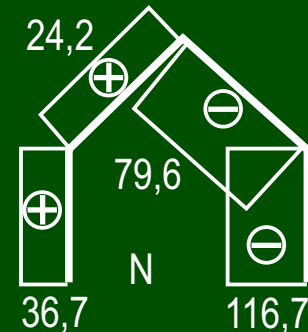
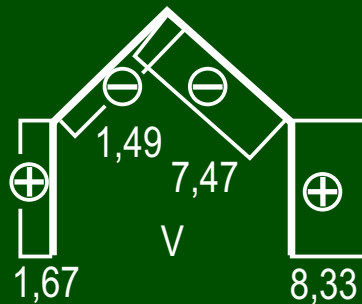
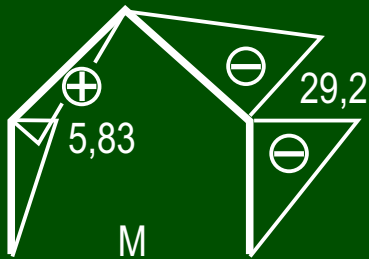

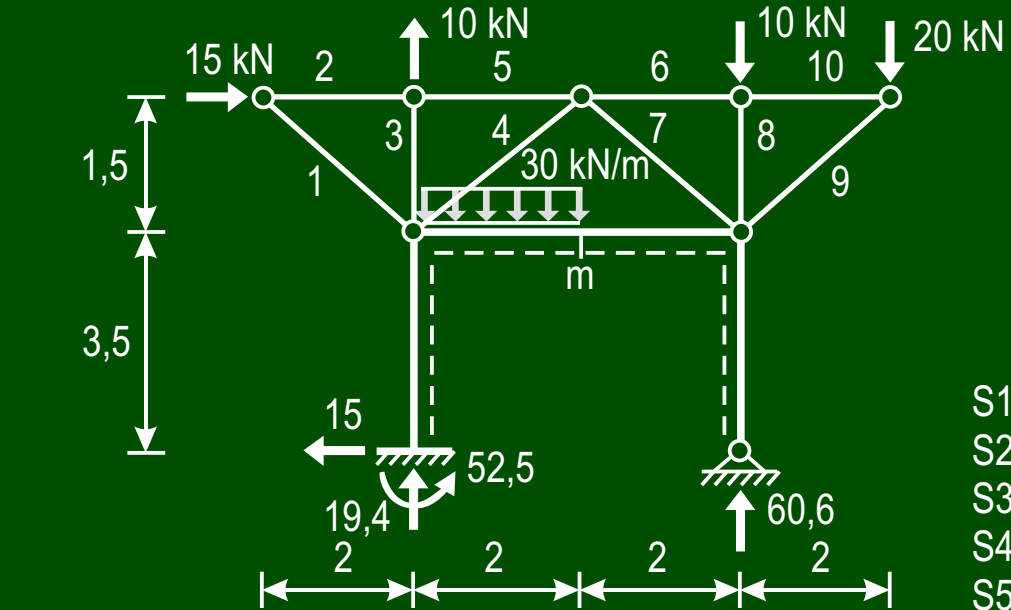

- S1 = 0
- S2 = - 15
- S3 = 10
- S4 = 26
- S5 = - 15
- S6 = 26,6
- S7 = - 26
- S8 = - 10
- S9 = - 33,3
- S10 = 26,6

